

Ceiling-mounted spotlight fitting

5905339268334



MO
DE
RN
design

HIGH
quality
finish

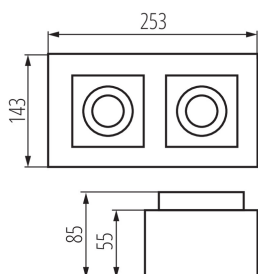

The Kanlux STOBI is the line of ceiling fixtures, with a replaceable light source. They are in aluminium with a fully adjustable light-beam angle. The high-quality finish (matte, sanded surface), and simple style, make the fixtures perfect for rooms at home, and also for offices and apartments.

GENERAL DATA:

Colour: white

Place of assembly: ceiling mounted

Place of application: Indoors

Minimum distance from the illuminated object: 0,5m

The product is not suitable to be covered with a heat-insulating material: yes

Length [mm]: 253

Width [mm]: 143

Height [mm]: 85

TECHNICAL DATA:

Rated voltage [V]: 220-240 AC

Rated frequency [Hz]: 50

Maximum power [W]: 2 x max 10

Class of protection against electric shock: I

Light source: PAR16

Light source included: no

Cap: GU10

Ambient temperature range to which the product can be exposed: 5÷25

Enclosure material: aluminum alloy

Connection type: Bolt terminal block

Range of sections of wires used [mm²]: 1÷2,5

Lighting-fixture angle regulation: in two axes

Lighting-fixture angle regulation [°]: 65/45

IP class: 20

LOGISTIC DATA:

Packaging method: 10

Number of units in the secondary packaging: 1

Number of units in the packaging: 10

Net unit weight [g]: 940

Grammage [g]: 1096

Length of a unit pack [cm]: 26

Width of a unit pack [cm]: 15

Height of a unit pack [cm]: 9.5

Weight of a cardboard box [kg]: 10.96

Width of a cardboard box [cm]: 27.5

Ceiling-mounted spotlight fitting

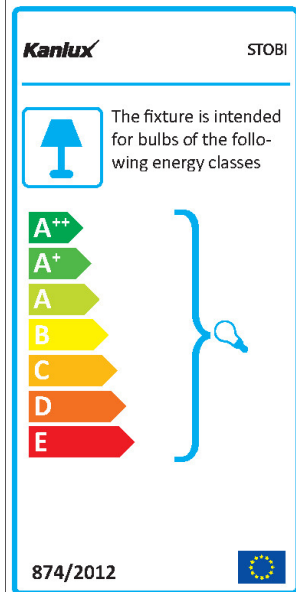

Height of a cardboard box [cm]: 32
Length of a cardboard box [cm] : 50
Volume of a cardboard box [m³]: 0.044

